

GUARANTEED  
5 years



# TECHICAL SHEET E.30

## OUTDOOR CABINET WITH ELECTRICAL CONNECTION FOR AUTOMATED EXTERNAL DEFIBRILLATORS

### PRESENTATION

The E.30 outdoor cabinet is a universal cabinet that fits all defibrillators. It consists of a transparent cover and a support bar and a thermoregulation system (heating and ventilation). It is designed for outdoor installation with an alarm system and LED.

The cabinet is made of polypropylene (PP) and polyéthylène (PET Grifen). 100% recyclable (shock-resistant material, insulating, fire-retardant and rot-resistant treatment material).



Light to reduce transportation costs (limits carbon impact).

Innovative and modern Design.  
French Manufacturing.



### SIGN

- On the cabinet, a location is provided to paste the maintenance tracking sheet.
- Inside the cabinet, a location with a QR code refers to the different datasheets of the different devices.
- On the transparent cover, a sign is displayed with the pictograms of the survival chain.
- The different AED DAE logos and labels and the standard heart are moulded on the transparent and UV-resistant cover (Grifen).

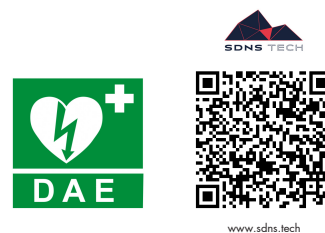

**SDNS TECH**

**1 massage cardiaque + 1 défibrillateur c'est 10 fois plus de chance de survie !**

**Appeler les secours**  
au 15 ou 18  
ou 112

**Masser la victime**  
sur une base de 30 à 100 compressions/mn

**Définir**  
en attendant l'arrivée des secours sur place

SDNS TECH | ☎ 04 80 81 84 80 ou 06 98 31 24 08  
contact@sdns.tech | www.sdns.tech | Société Hélicoptère 455 rue Louis Armand 73420 Méry - France

### 4 COLORS AVAILABLE FOR YOUR CABINET



GUARANTEED  
5 years



## TECHNICAL SHEET E.30

Read the operating instructions and instructions for use carefully.

SDNS TECH cabinets are designed to receive automated external defibrillators (AEDs). The I.10 and I.20 cabinets are designed to be installed indoors.

E30 and ES.40 cabinets are designed for outdoor installation.

cabinets do not replace mandatory AED controls and maintenance as per manufacturer protocols.

Warning, before the installation please take off the protection film from the transparent cover. The hardware is not included.

### WARRANTY

SDNS TECH AED cabinets are guaranteed 5 years (excluding electronics components guaranteed 2 years) from the date of acquisition by the distributor from the company D-SECURITE GROUPE which is the exclusive distributor. Any changes to the E.30 will void the warranty.

Upon receipt of the cabinets, check the conformity of the products and, in the event of a defect or non-conformity, immediately inform D-SECURITE GROUPE in writing and communicate to it all information likely to characterize the nature of the defect observed.

Also excluded from any warranty, normal wear and tear of the cabinets, any consequence of negligence, lack of monitoring, lack of maintenance, failure to monitor or maintain a false operation not attributable to D-SECURITE GROUPE, from any improper use or a modification or repair made without the written consent of D SECURITE GROUPE.

No claim of any kind may be made more than 15 days after the discovery of the cause of the claim.

### TECHNICAL DESCRIPTION

Chest material : PP (Polypropylene) Material

Cover material : PET Griffen (Polyethylene)

#### Weight of main cabinet components :

- Chest without cover: 1.894 lb / 0.859 kg

- Cover without chest: 0.494 lb / 0.224 kg

- Transformer, fan, fan cable, heater board, probe, electronics card : 0.761 lb / 0.345 kg

- Overall weight : 3.307 lb / 1.5 kg

Dimensions : W 15.354 inch / H 18.386 inch / D 8.268 inch

W 390 mm / H 467 mm / D 210 mm

220 V power supply

Maximum consumption: 20 mA

**Caption :**

1. Lower Trunk Cover
2. Electronics card with cover opening sensor and brightness sensor (for I.20-E.30 and ES.40 enclosures)
3. Transformer (for E.30 cabinets)
4. Temperature Probe (for E.30 and ES.40)
5. Fan Cover
6. Fan (for E.30 and ES.40 cabinet)
7. Chest
8. Bar code label for online user manual
9. Hot Plate (for E.30 and ES.40)
10. Defibrillator Support Bar
11. Grifen Anti-UV Cover

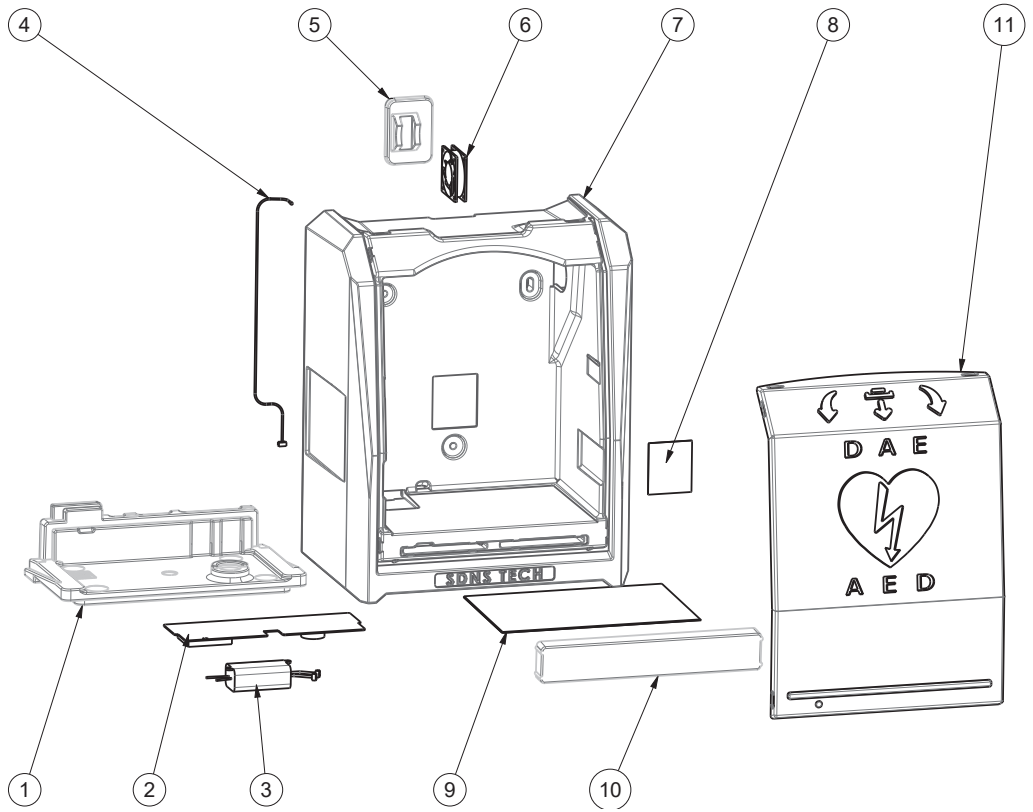

Parts and consumables can be ordered separately.

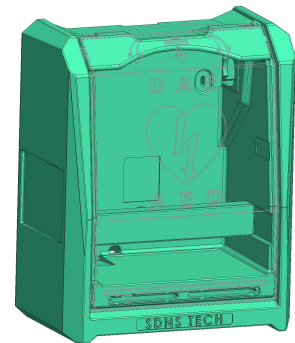
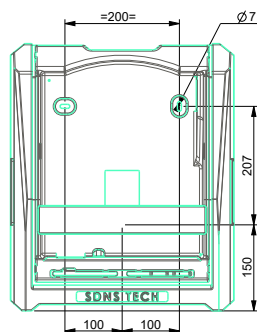
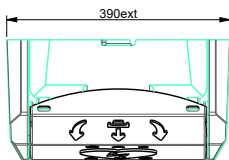
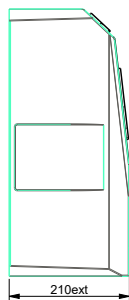
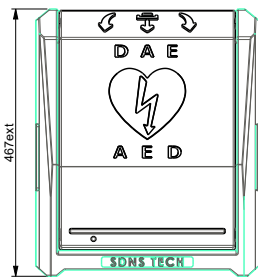

Cover + Chassis + Support bar

## INSTALLATION TIP

To know the installation conditions, you must contact your distributor for installation advice (type of attachment, conditions, clearance, etc.).

Comply with road installation obligations according to the laws of the country in force.

For the electrical connection of the E.30 enclosures, an installation diagram is available below. You can install seals on the trunk to check if the cover has been opened.

The cabinet can replace a cabinet of another brand already installed, taking the existing connections. In outdoor installation, we recommend that you prefer cabinet of green and white color to limit the rise in temperatures.

A 12 to 24 V transformer is included for the cabinet connection, even in case of insuitability to the power line. As an option, we offer a voltage connecter that can be switched from 24 V to 12 V.

### General low voltage panels operating

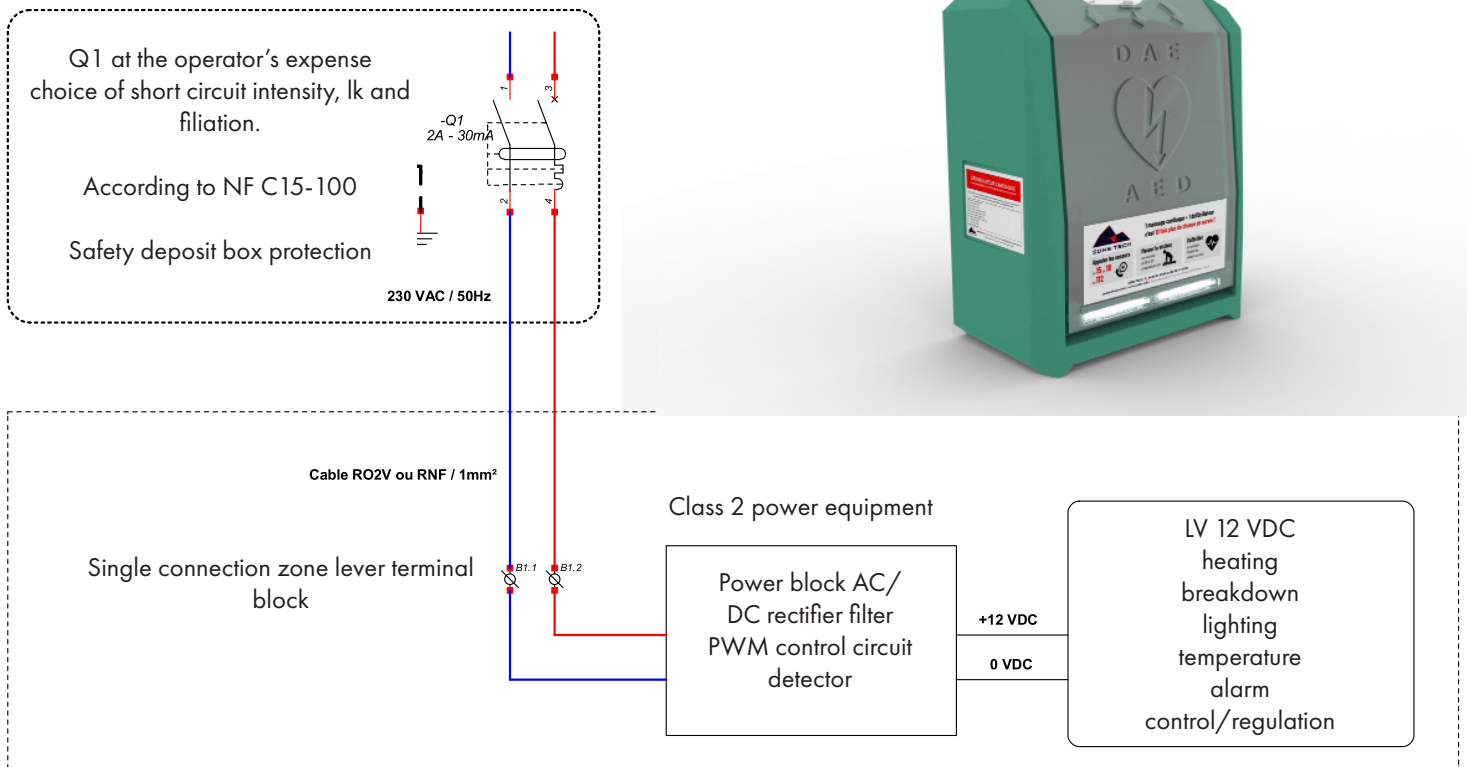

## FUNCTIONING

The boxes E.30 and ES.40 have a green led lighting system during the day. In day mode, the leds are green and flash every 2 seconds.

In night mode thanks to a light sensor, the LEDs are fixed white with flashing green LEDs every 15 seconds.

When the hood is open, the leds will flash red and the alarm will sound every 32 seconds intermittently. The alarm has a maximum current of 100 dB and a voltage of 12 V, the sound level decreases to 90 dB in normal operation.

### **Vent :**

ON above 20°C

OFF below 17°C

### **Heating :**

OFF above 5°C

ON below 2°C

If the cover is open, heating and ventilation will stop.

# DECLARATION OF CONFORMITY CE

This certificate certifies that the product below complies with the specifications indicated and has been tested in accordance with our obligations in accordance with BS EN ISO 9001:2015. It also confirms - if applicable - that static sensitive products have been handled and packaged with care in accordance with ANSI/ESD S 20.20:2014 and BS EN 61340-5-1:2016 regulations and technical conditions.

En complément et en équivalence la Directive 2001/95/CE relative à la sécurité générale des produits.

Le bloc de puissance est conforme à la directive (2014/35/EU) – EN62368-1 :2014+A11 :2017  
EN 55032 :2015 Class B // EN 61000-3-2 :2014 // EN 61000-3-3 :2013

EMS (Electro-Magnetic Susceptibility) : EN 55024 :2010+A1 :2015

## Product(s) Information

Models

I.10 / I.20 / E.30 / ES.40

Product Description

## Cabinet for defibrillator

Brand/Model :  
**SDNS.TECH**



RoHS Compliance Statement

Directive EU 2011/65/EU and (EU)2015/863 limits the use of the 10 substances in the manufacture of certain types of electrical equipment.

For accessories such as outdoor poles and mounting brackets the passive safety and test method refers to the NF EN 12767.

VI2 - 12.04.2024 - EL



French Manufacturing

5



[www.sdns.tech](http://www.sdns.tech) | [contact@sdns.tech](mailto:contact@sdns.tech)

+33 (0)6 10 15 76 75

Exclusive distributor: D-Sécurité Groupe

Distributed by :